

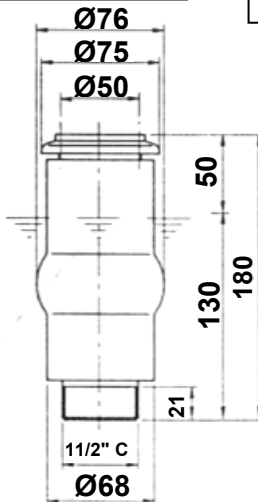

Bubble Jet Nozzle

The Bubble Jet / Schaume white foam spraying nozzle, contrast to Giant Cascade and Sky Geyser, function independently from the water level. Change in the water level has no effect on the water pattern. When water runs into the basin, for stepped pools or fountain installations with a lower reservoir, this nozzle type has wide field of application, since return valve, which are often troublesome, are unnecessary here. Due to the high quantity of air that is mixed in, a voluminous water effect is achieved with a relatively small quantity of water. This makes the foam jet very soft, highly compact and exceptionally foamy. It stands out, highly contrasted against its surroundings.

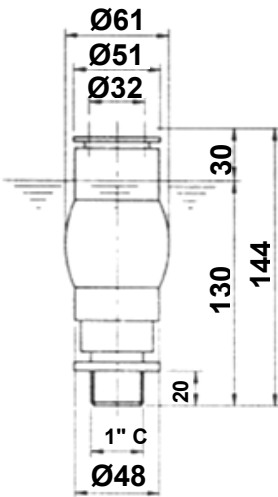
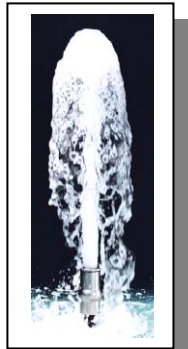
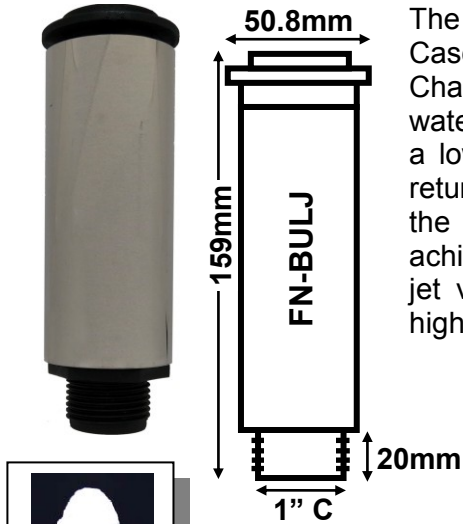

Schaume 35-10E
FNS35-10E



Schaume 55-15E
FNS55-15E

- C = Connection
- FH = Fountain Height
- NPB = Nozzle Pressure Demand
- PD = Nozzle Pressure Demand
- GW = Gross Weight
- MA = Material

Hydro Data	Bubble Jet – 1" connection		
	NWD	NPD	NPD
FSH	L/min	mWS	Bar
1.00m	81.23	2.76	0.28
1.25m	89.77	3.38	0.34
1.50m	97.57	3.99	0.40
1.75m	104.79	4.61	0.46
2.00m	111.55	5.23	0.52
2.50m	123.97	6.46	0.65
MA	Stainless Steel and Nylon		
GW	0.4kg		

C.	Schaume 35-10E		Schaume 55-15E	
	1"		1 1/2"	
Hydro FH	NWD L/min	NPD Bar	NWD L/min	NPD Bar
0.25m	47.10	0.10		
0.50m	55.10	0.14	125.00	0.11
0.75m	71.18	0.22	151.69	0.15
1.00m	80.73	0.28	176.45	0.19
1.25m	89.27	0.34	198.16	0.24
1.50m	97.07	0.40	217.74	0.28
1.75m	104.29	0.46	235.70	0.33
2.00m	111.05	0.52	252.40	0.38
2.50m	123.47	0.65	282.90	0.48
3.00m			310.45	0.58
3.50m			335.78	0.64
4.00m			359.37	0.77
4.50m			381.53	0.87
5.00m			402.51	0.97
6.00m			441.56	1.16
7.00m			447.53	1.36
MA	Stainless Steel and Plastic			
GW	0.5kg		1.4kg	

